

VENTILATION THROUGH RIDGE CAP

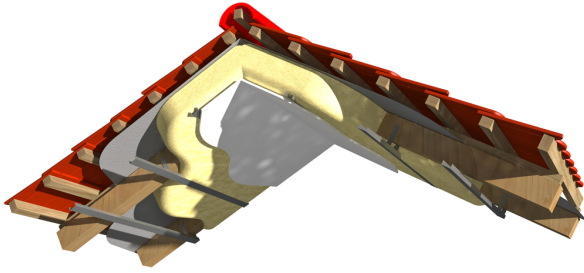

STRUCTURE CHARACTERISTICS:

- PITCHED ROOF WITH BREATHABLE UNDERLAY
- THERMAL INSULATION BETWEEN AND OVER TIMBER RAFTERS
- WITH PLASTERBOARDS
- INTERNAL FINISH

STRUCTURE ADVANTAGES:

- VAPOUR OPEN
- AIRTIGHT
- SOUND RESISTANCE
- SPEED OF INSTALLATION
- TIMBER PARTS INVISIBLE FROM INTERIOR
- REPLACEMENT OF EXISTING INSULATION WITHOUT INTERVENTION TO INTERIOR

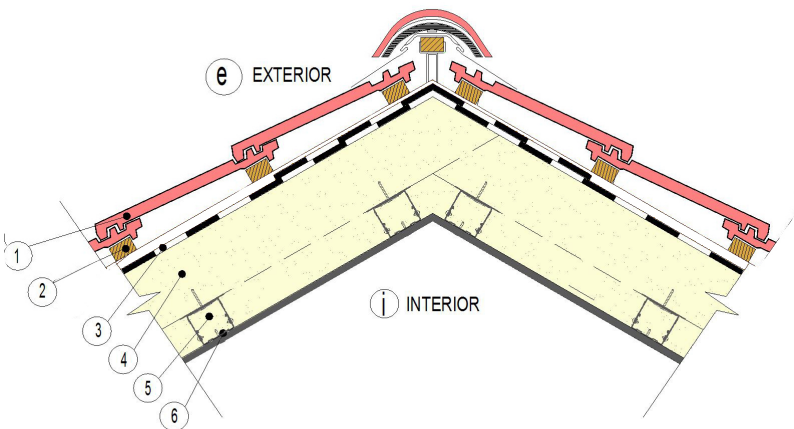

THERMAL TRANSMITTANCE VALUE ACCORDING TO B.S.EN

REQUIRED THERMAL TRANSMITTANCE VALUE U [W/m²K] 0.18

CALCULATED THERMAL TRANSMITTANCE VALUE U [W/m²K] FOR:

ICYNENE H2FOAM LITE (LDC-50) 0.19
 ICYNENE H2FOAM LITE PLUS (LDC-70) 0.18
 ICYNENE H2FOAM FORTE (MDR-210) 0.16

TECHNICAL PARAMETERS OF STRUCTURE

LABEL	LAYER	THK. [mm]	DESCRIPTION
1	SLATES/TILES	—	ROOF COVERING
2	BATTEN	—	SUPPORT STRUCTURE BASED ON ROOF COVERING
3	WURTH THERMO ND / DORKEN DELTA-MAXX / TYVEK SUPRO	0.2	WEATHER RESISTANT BARRIER / VAPOUR OPEN PERMEABLE UNDERLAY
4	RAFTER - ICYNENE SPRAY FOAM	140	RAFTER 120/140, 400-600MM CENTRES / THERMAL INSULATION LAYER
5	FURRING CHANNELS - ICYNENE SPRAY FOAM	60	SUPPORTING STRUCTURE / THERMAL INSULATION LAYER
6	PLASTER BOARD	12.5	INTERNAL FINISH